

# Clock movement (Street typ)

Autonomous clock movement with embedded control, applicable for street clocks, musical street clocks and smaller tower clocks.

## Features

- Max. 2000mm clock face size (at 120kph wind speed)
- Electronic carillon option
- Automatic, autonomus clock movement, regulated on the right time
- No user interface, configurable via ANSI/VT100 terminal
- Controlled DC servo with regulated speed and torque
- Integrated electrical absolut sensors for position feedback
- Temperature compensated quartz timebase
- Integrated power electronics without electromechanical relays
- Automatic daylight savings time change
- Automatic setting after power failure (uninterruptible operating is an option)
- Compatible with GPS and DCF77 time systems
- No need of external impulse as a slave clock
- Able to drive up to 64 slave clocks, max. distance: 2000m
- Diagnostical functions via terminal
- Servicing cca. 10 yearly

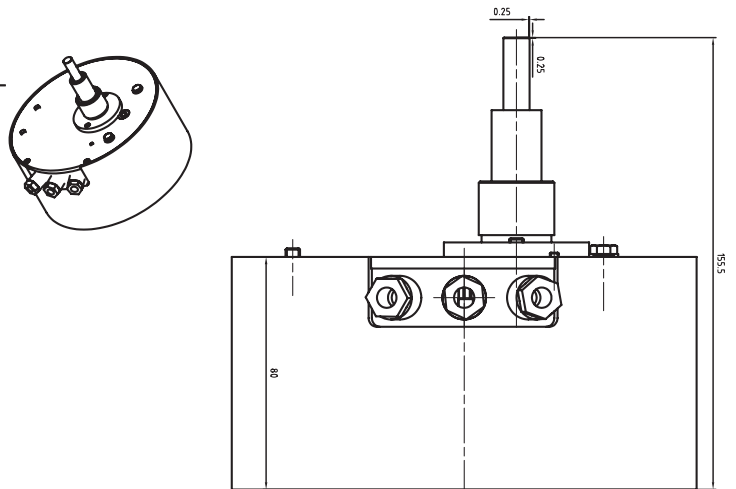

## Specification

- 160mm diametered, 80mm high cylindric movement casing
- 17/9 axles
- Variable axle length, easy to install
- Weight: 2kg
- 230V/6VA, AC power

